

Bream Bay News

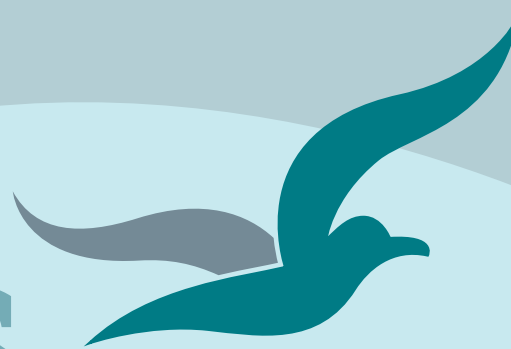

Est.1967 | Locally owned and operated | Delivered FREE twice a month 7 December 2023

Affordable Quality

- * SECURITY DOORS
- * INSECT SCREENS
- * SHOWER DOORS
- * BLINDS
- * AWNINGS
- * WARDROBE SYSTEMS

www.homeplus.co.nz



34 Albert St
Whangārei

Est. 1977

PH: 438 9452

whangarei@homeplus.co.nz

Plans for 50 new Kāinga Ora homes in the Ruakaka Village

Kāinga Ora has upped its plans and now proposes to build 50 new homes to replace its existing 16 properties on a block along Tiki Place, Peter Snell Rd. and Tamingi St.

Te Tai Tokerau Regional Director Jeff Murray said the public housing provider intended to apply for resource consent early in the New Year. The agency is undecided yet whether the new houses will be built in one or two stages. Existing Kāinga Ora tenants would be rehoused in the interim and then would have first choice of the new homes.

Jo Haunui, the Manager of Regional Placements for Kāinga Ora in Northland, said she had met with the affected tenants. Two had indicated they would be happy to move to Whangārei while another 10 have said they would like to remain in the Ruakaka area.

Six houses under construction for Kāinga Ora in Peter Snell Rd. with an expected completion date in March would be used to house some of the displaced tenants.

Mr. Murray said the resource consent application would be for two, three and four bedroom homes. These would be a mix of single and two storied with bedrooms upstairs.

Mrs. Huanui said the whare would be built in such a way that there will be a fenced outdoors area big enough for a trampoline for children to play on.

Continued on Page 5

The Villy Day Out team



The organisers - Bobby Joe Paikea, Melody Gardner, Alishea Paikea-Paul.

After two years when it couldn't happen because of Covid 19 precautions, The Villy Day Out returned to the Ruakaka sports grounds on Saturday 18 November bigger and better than ever. Even wet weather didn't stop the fun with free hangi provided by the Pumipi family, free sausage sizzle, free iceblocks and free rides and entertainment. Bream Bay St John was there as was the Ruakaka Fire Brigade, Bream Bay Police, The Bream Bay Community Trust, Safe Men Safe Family and a host of other service providers.

More photos on pages 10 and 11



Langs Beach 15 Blue Moon Rise

516 sqm  3  1  2  1  1 

Asking Price \$1,250,000

Christine Birss 027 235 4323 christine.birss@bayleys.co.nz

MACKYS REAL ESTATE LTD, BAYLEYS, LICENSED UNDER THE REA ACT 2008

Beach bonus, from this early Christmas cracker

Christmas is coming – you could be in here. No waiting for a house to be built, as this is ready for you now. Are you ready to reward yourself?

This house was just built in 2020, so includes benefits like double-glazing. Current owner has looked after it so well, that it really feels just like a new home.

Open plan living easily interfaces with the north-facing deck, encouraging friends to want to visit as often as you allow.

Easy to lock & leave, or live in permanently – which option suits you best?

Walk to the beach, as it's within easy reach for those who are fit.

bayleys.co.nz/1153445

BAYLEYS



Rick Stolwerk
Coastal South Councillor for
Northland Regional Council

If you have any general questions on
environmental issues, pest management control,
maritime safety concerns or specific questions
in relation to my role as Chair of the
Northland Regional Council's
Sub Committee - Investment and Property,

Please contact me by phone or email

09 432 0741 or 021 823 770
ricks@nrc.govt.nz

GIFT SHOP

A great place for gifts

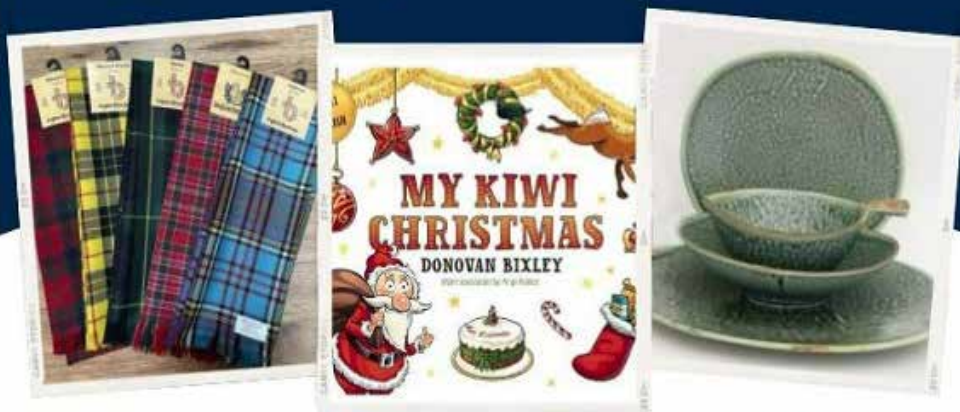

36 The Centre, WAIPU 0510



THE BREAM BAY NEWS

is published by Bream Bay News Ltd. Address : RD 2, Waipu
 Phone : (09) 432 0209 Mobile: 027 432 0070 Email : breambaynews@xtra.co.nz
 Website: www.breambaynews.co.nz
 Editor: Marilyn Cox . Accounts : Susan McRae. Technical assistance... Geoff Spencer
 Advertising design and website maintenance... Megan Lea.
 Printed by NZME
 We distribute 5900 copies twice a month in Ruakaka, One Tree Point, Waipu,
 Mangawhai and Maungaturoto

EDITORIAL

In the public interest

This morning I watched Jack Tame interview Christopher Bishop, the newly appointed Leader of the House of Parliament on his talk show Q and A.

Asked about the justification for his government's move to repeal the anti smoking legislation that would have banned cigarette sales to younger generations, limited the levels of nicotine in cigarettes and curbed the number of stores permitted to sell cigarettes from over 6,000 to around 600, Mr. Bishop came out with the New Zealand First line that this would result in a black market sales and ram raids on the stores where cigarettes remained on sale. He repeated an incorrect statement Prime Minister Christopher Luxon had made at an earlier press conference saying that, under the now scrapped legislation, there would have been just one cigarette outlet in the whole of Northland.

Mr. Tame pointed out that a Ministry of Health paper stating where cigarette sales would be sold, listed 35 Northland cigarette outlets. I looked this up myself to find there would have been outlets scattered around Northland including one in One Tree Point and another in Ruakākā.

The Ministry of Health had made its calculations taking into account populations, number of smokers and travel times. The smoke free legislation, which would have seen cigarette smoking completely phased out over a number of decades, had been carefully thought out and planned and is now being emulated in the United Kingdom. It seems in its rush to wipe out all traces of the previous government Mr. Luxon and his teams haven't bothered to check the facts

I heard the Prime Minister's comment in answer to criticism about the co-alition governments urgent lodging of a reservation to a minor World Health Organisation resolution as pandering to conspiracy theorists when he said "we don't listen to anything the Labour Party says".

This sounds like petty spite. Wouldn't it be in New Zealand's best interest to first carefully consider some of those major pieces of work undertaken by the previous administration such as: Three Waters, Resource Management reform, The Therapeutic Products Bill and alter what you don't agree with rather than this wholesale binning.

We seem to be heading down the same path as the United States where the divide between the two main political parties has become so bitter and antagonistic that it is very difficult to pass operating budgets let alone any legislation to move that country forward.

I recall when John Key led the National Party to victory in the 2008 election he didn't repeal the popular Kiwisaver scheme established by the previous Minister of Finance Michael Cullen, although it did get tweaked a bit.

This partisan uncompromising attitude seems to have spread to the Northland Regional Council where four councillors re-elected in 2022 have been ousted from most of the committees they served on by five first termers. I watched the NRC meeting of 28 November on You Tube after reading Susan Botting's report in the Northland Advocate. I was appalled at the way that meeting was conducted and by the loss to Northland of the knowledge and commitment of the ousted four.

The Northland Regional Council has 285 staff and a \$76.9m operational budget. It manages the air, land, freshwater and coastal resources of the Northland region. It also co-ordinates civil defence, transport and economic development. We need to keep a closer watch on what is happening there.

Incidentally, government funding for public interest journalism supports both Jack Tame's Q and A TV1 programme and Susan Botting's local government reporting in the Northern Advocate. We need this to remain.

Marilyn

HAMMER HARDWARE

It's your local

For all your Household Needs, DIY and Gardening Supplies,
Fencing Equipment, Plumbing & Electrical Fittings.

Your one stop Christmas shop

OPEN 7 DAYS Monday - Friday 8:00am - 5:00pm
 Saturday 8:00am - 4:00pm | Sunday 9:00am - 3:00pm
 Public Holidays 9:00am - 3:00pm

Waipu Hammer Hardware | 35 the Centre, Waipu | 09 432 0292

Shut the road, do it properly and be done with it.”

State Highway One over the Brynderwyns will close for some major repair work for two months later this summer. A sum of \$61million dollars has been approved for the work but the timing of the closure has yet to be confirmed with a balancing act required between the need to complete the work during the drier, warmer months while avoiding the busy summer holiday period which many Northland business rely on to maintain profitability. While some believe the closure will begin immediately after Waitangi day, retail and accommodation providers favour a later starting date after the Easter break. The bypass routes also have yet to be decided although likely to be through Mangawhai and Waipu for lighter traffic and over the Oakleigh/ Paparoa road for larger vehicles.

Paul Jensen of Fresha Valley, whose trucks travel to Auckland to deliver milk seven days a week said, “It’s got to be done. Patching it up is never going to work. Shut the road, do it properly and be done with it.”

Those two months with the highway closed are going to cost his business an estimated \$8,000 a week. He is hoping his smaller rigid trucks will be able to travel via Mangawhai, which involves an extra 45km each way. Four of these trucks carry Fresha Valley milk to Auckland seven days a week.

In addition three truck and trailer units carry milk to Auckland five days a week. These will need to travel via the Oakley/Paparoa Rd. - an extra 70km each way. It will be difficult for drivers to do this return trip and deliveries within the 13 hours maximum time truck drivers can work and he may need to put on extra staff. There is also the wear and tear on his fleet from driving over the bypass roads. He said the cost of truck repairs was horrendous when the highway was closed following Cyclone Gabrielle in February 2023.

Ian Newey of the Ruakākā based log-hauling company Newey Transport had some strong words to say about the state of the road over the Brynderwyns. He is also the Deputy Chairman of the National Road Carriers Association so has a good understanding of what the proposed two month closure will entail.

He says the closure needs to happen so the road can be repaired to last for another seven years while an alternative route is built. He believes if work doesn’t go ahead we could end up with a situation as exists in the Mangamuka Gorge where, the highway has been closed for years after some massive slips in 2022.

He is adamant that building a bypass to the Brynderwyn Hill should be a priority.

“Every man woman and child in Northland should be



Major slips on the Brynderwyns need urgent and major remedy work. Photo from the Waka Kotahi website.

standing on a hill and shouting this out. For decades there has been under investment on Northland roads and now we are at rock bottom.”

“Now is our time. We have a good number of Northland based MPs. We should be able to get this done.” With other representatives of the National Road Carriers he plans to drive over the proposed bypass routes for the two- month stoppage to inspect upgrades Waka Kotahi is making.

He said having a planned closure of SH1 won’t be quite as bad as the forced closure earlier this year and Waka Kotahi has been consulting with his organization along with other Northland’s business and political leaders.

But all those extra kilometres trucks will need to travel will hurt local business and the Road Carriers will be asking for some funding assistance from the Government to help.

Ian said having a funding buffer would encourage trucking companies not to use the shorter and more dangerous routes such as Gorge Rd. and help to keep the roads safer for all users. Antoinette Laird,

communications advisor for the National Road Carriers Association said, “As it stands, State Highway 1 through the Brynderwyns is prone to further slips and prolonged closures, and with every passing day we risk the road being closed permanently. If this happens direct access to Northland will be cut off indefinitely while Waka Kotahi undertakes a bypass. She said, the section of State Highway 1 over the Brynderwyns “consists of seven or eight corners all delicately balanced on a steep slope. Repairs require space to be dug out of the uphill slope to move the road across while the existing series of under-slips are simultaneously remedied. This work cannot occur while the road remains open, there is simply not enough space. Repairs are a critical priority due to the precarious state of the road. They will buy the road an additional seven years of life, which will allow authorities to build the bypass. To do nothing is not an option. She said, “Learnings from recent weather events are being used to facilitate planned diversions far more safely and effectively – a

Continued on page 7

Building in Whangarei, Kaipara, Far North



Frankton 105sqm

\$330,750 incl gst

Includes: plans, consent, kitchen, appliances, tinted double glazed windows, tiles, carpet, blinds, heatpump.



Wayne Pickerill
Managing Director

“Hi, I’m Wayne Pickerill, Managing Director and Project Manager for your new Fowler Home. Enjoy quality and all the benefits of dealing with an efficient, low overhead, nationwide company, where I will take a personal interest and be involved through to completion.”



More designs at www.fowlerhomes.co.nz or visit our office at 63 Walton St, Whangarei. Phone Wayne Pickerill 438 4840

**FOWLER
HOMES™**



Athletes foot

Is the skin between your toes peeling? Do your feet have a rather whiffy aroma? If so, you may well have athletes foot.

Although the experts are divided as to whether athletes foot



(Tinea pedis) is worse during the heat of summer - or the cold winter months when your feet are couped up in shoes all day - either way this condition can spread like wildfire through your household unless treated immediately.

Athlete's foot is caused by a group of fungi called dermatophyte fungi that grow in warm moist environments and can cause infection in the skin. It spreads easily through direct skin-to-skin contact or indirectly through contact with infected surfaces – like sharing towels, shoes and bath mats. It can also be caught by walking barefoot in warm damp areas like communal showers, gyms, swimming pools or changing rooms. Secondary infection can occur if skin is split, bleeding, or blistered.

Athlete's foot commonly affects the skin between the toes – particularly between the fourth and small toe. The skin may appear soft, white and peeling but can also be red, itchy and scaly. It can also sometimes spread to the sole of the foot where it appears dry, cracked and scaly. Other symptoms include itching, burning, stinging, small blisters, fissures (splitting) and bleeding.

The good news is that athletes foot is easily treated by using creams and powders.

Antifungal creams work by preventing fungi from multiplying (fungi-static), or by killing fungi directly (fungi-cidal). Fungi-static antifungal creams need to be applied for approximately two weeks after the infection has cleared, while fungi-cidal antifungal creams can be stopped once the infection has cleared.

Antifungal powders are good for dusting in shoes or socks to kill residual fungal spores and prevent reoccurrence, while corticosteroid creams help reduce itch and inflammation. Corticosteroid creams must be applied sparingly and used strictly according to product recommendations and the advice from your community pharmacist.

It is a good idea to talk to your community pharmacist for advice on using these products. Some products contain both an antifungal and a corticosteroid so you will need to ensure treatment is not duplicated.

Your community pharmacist can also advise you on making lifestyle changes so that you can minimise the risk of getting athletes foot in the future.

LETTERS

Concern non compliance with the Road Code could lead to a serious accident at McCathie Rd./Marsden Highway intersection

It would appear that about 50% of the drivers coming off the STOP sign on One Tree Point Road turning right at the offset intersection with Port Marsden Highway (S H 15) and McCathie Rd are unfamiliar with the Road Code.

Drivers of cars on Port Marsden Highway heading towards the Port which are turning right into McCathie Road and have signalled their intention to do so have the right of way. It is my understanding that when on a STOP sign you give way to all other traffic.

I am worried that there will be a serious crash. Many times over the past years cars have come off the STOP sign and I have had to slam on my brakes to avoid a collision when turning right into McCathie Road. I am aware of the problem but motorists unfamiliar with the area would not be.

Gaye Cann
Ruakaka

Save Our Dairy - Cones mean no trumpets

The road cones set out on the roadside opposite the Dairy have killed off half the business for the dairy overnight. The cones are soon to be replaced with a footpath that less than 1% of the Cove foot traffic will ever use. All of those Tradies and Travellers will have nowhere to pull over and grab a quick ice cream or drink.

I live across from the Dairy and yes, it would be nice to have a footpath on our side of the road, but not at the expense of all those people that throughout the year pull over to pick up a refreshment.

The traffic calming measures mean that it will be a whole lot safer for people to pull over and nip across the road.

Save our Dairy, give NTA the clear message we don't NEED that footpath, we NEED that space as a pullover zone for travellers, throughout the year, to grab an ice cream, coffee or some fish and chips.

The road is just about to be ripped up, please, help stop this madness.

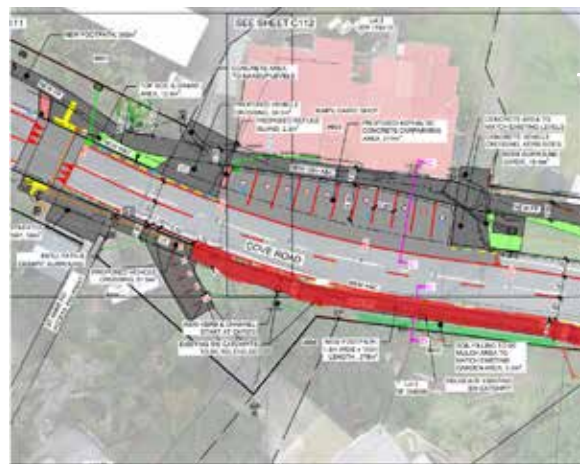

North bound
nowhere to
stop!

Footpath to
replace existing
pull over area.

Angus McCulloch
Waipu Cove



Phone the BREAM BAY NEWS - 09 432 0209
or email:breambaynews@xtra.co.nz
if you know of something interesting going on in
Bream Bay.

The final issue for 2023 will be published on
Thursday 21 December.

Deadline for advertising is Wednesday 13 December

Plans for 50 new Kāinga Ora homes in the Ruakākā Village

Continued from Page 1

Asked about pets she said this would be considered on “a case by case basis.” Once the existing tenants have been provided for “we will look at the wait list and there will need to be a genuine connection to the community either through mahi (their work) or through whanau support.” She said in previous developments in Te Tai Tokerau outsiders moving in have mostly been people wanting to return home to Northland.

She urged Bream Bay people living in overcrowded or unsuitable conditions to apply to the Ministry of Social Development to put their names on the housing waiting list. Asked about the procedure when people living in Kāinga Ora homes behave in an anti social way disturbing to people living nearby, Mrs. Haunui said attempts are made to find more suitable homes for people “who have been playing up.” They usually agree to move but if necessary there is legal provision to force them to relocate to another Kāinga Ora property considered more suitable. This has only been used twice in Northland. The tenants of a Kāinga Ora home in Tiki Place to which Police were called 56 Police times between January and August 2023 have, after two years, agreed to move out of the Ruakākā Village. Transitional Housing, where people who struggle to live in a community are provided with wrap around support services, is not available in Northland.

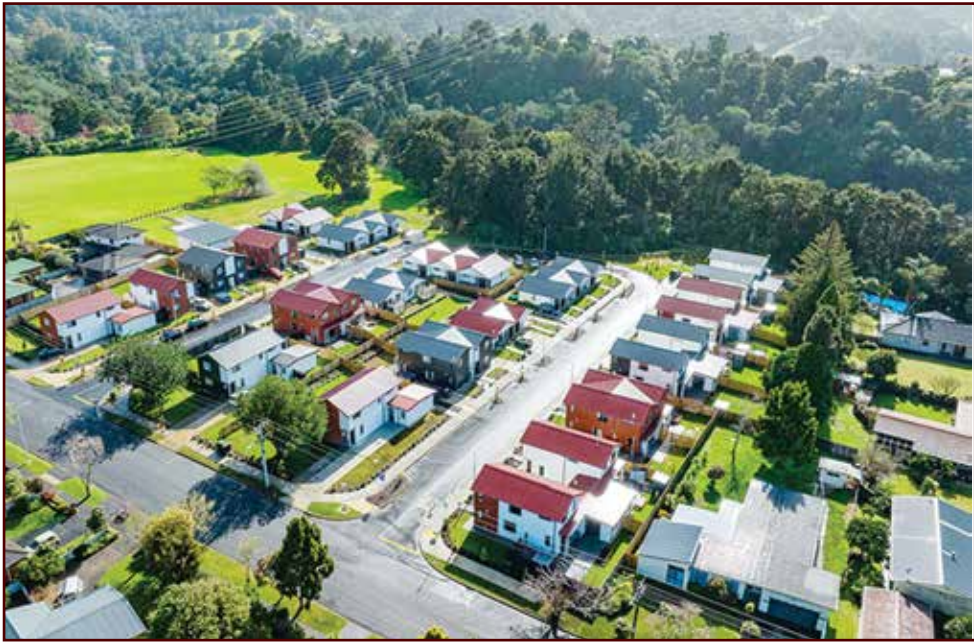

Kāinga Ora housing in Whangārei's Puriri Park Road

Kāinga Ora is holding an all day drop in session (10am – 6pm) on Thursday 7 December at the Bream Bay Community Trust followed by two morning drop in sessions on Thursday 14 and Thursday 21 December from 9am – 10.30am. Mrs. Huanui has also offered to take a tour of the Kāinga Ora housing development at Puriri Park which she said, although the Ruakākā development will not be the same, would give an idea of the kind of homes the agency builds. There are currently 1100 households on the waiting list for homes in Northland. Twenty of these families are considered in urgent need by the Ministry of Social Development, Mrs. Haunui said this urgency is often because whanau members suffer from rheumatic fever and need to live in warm and dry homes. Kāinga Ora currently has 28 homes in the Ruakākā area – two of these in One Tree Point, one on Marsden Point Rd. but most in the Ruakākā Village. It has no properties in Waipu.

Bream Bay Garden Maintenance

Landscaping • Planting • Raised Beds
Decks • Hedges trimmed • Trees pruned
Weed control • Section Tidy Up
• Simple Building jobs•

Free Quotes

NO JOB TOO SMALL

One Offs, Weekly, Fortnightly or Monthly

Phone Marcus 021 343 727

BREAM BAY CURTAINS BLINDS AND SHUTTERS

PH 0204 632 432
FOR A FREE IN HOME CONSULTATION
CALL SUE

AVAILABLE 7 DAYS A WEEK COVERING
WHANGAREI TO MANGAWHAI INCL KAIWAKA
BBCURTAINSANDBLINDS@GMAIL.COM

CALL SUE TODAY

0204 632 432



Custom built homes, to suit your lifestyle



Visit Our Display Home
80 Arcus St, Raumanga, Whangarei
10:30am to 2:30pm Mon - Fri



0800 FAST BUILD | WWW.ADVANCEBUILD.CO.NZ

BIG RED

TRUCKING

Owner /Operator Duncan Mackay

GENERAL CARTAGE SERVICE

Metal / Topsoil / Sand / Manure / Hay / Silage

WATER

Prompt Delivery And Reliable Service.

Healthboard Approved Drinking Water Carrier.

Call 021 070 8211



Police Report

Sergeant Simon Craig seconded to Whangārei for six months

Sergeant Mathew Nicolson is officer in charge at the Bream Bay Police station for the next six months filling in for Sergeant Simon Craig who has been seconded to work on a project in Whangārei.

Two Family Harm incidents

He reports two family harm incidents both in Maungaturoto. These resulted in reports being entered and follow up by the family harm team if required.

Two mental health call outs

Police assisted at two mental health incidents, one in Ruakākā where a woman was taken to Whangārei Hospital for assessment and on in Waipu where a man was referred to mental health services for a follow up.

In court after burnouts on public road

A young man will be appearing in the Whangārei District Court on a charge of operating a motor vehicle with sustained loss of traction after Police were notified of a group of young people doing burnouts at the Shoemaker Rd./ Mountfield Rd intersection on Sunday 26 November.

Missing person callout quickly resolved

Bream Bay Police responded to a report of a missing woman in One Tree Point where concerns were raised because of the woman’s medical condition. However she was found shortly afterwards at a One Tree Point location.

ATLAS

QUARRIES CONCRETE

Thinking concrete but don't know where to start?

Think Atlas Concrete

• We quarry the aggregate

• We manufacture the concrete

• We site visit to advise the best options

• We give you the choice of mix and colours

• We give a choice of local placers for you to choose

• We manufacture concrete to your requirements

• We stand by our product, you stand on it

Atlas Concrete

Your First Call for Concrete

Ph: 0800 888303 - Brynderwyn

or 432 5030 - Ruakaka

Our local hero medal winner

Sharon Carroll has been selected as one of the 100 Kiwibank Local Hero Medalists for 2024.

Sharon said she has no idea who nominated her but wants to thank them. “I also wanted to acknowledge all who have helped with the things I have been involved in. Whether this is through connecting through various volunteer community groups, through any of the crazy projects and events that I may have roped you into, or the ongoing work we do to ensure there are more equitable and inclusive opportunities for all within our community.” “This award represents all the mahi we do together, so from the bottom of my heart I want to sincerely thank you.” Her citation on the local hero website reads Sharon Carroll is widely regarded around Te Tai Tokerau Northland as a community legend: dedicating her life to supporting others through a wide range of programmes and initiatives. Her extensive volunteering record includes working for organisations like Swimming Northland, Bream Bay Swim Club, Waipu Cycle and Walkway Trust, Waipu Primary School, Bream Bay College, Waipu Lions as treasurer, Chair of the Northland Sports Coalition, intern on the Sport Northland Board and Parafed Northland – delivering inclusive sport, active recreation and play opportunities for



Sharon Carroll

Northlanders living with a disability.” Recently, she has taken on a new role as Community Liaison Manager for the home care service tlc4u2,

THE NEXT PUBLICATION DATE

of the Bream Bay News will be Thursday 21 December

The deadline for all copy is 4pm on

Wednesday 13 December

PETFOOD | FREE HOME DELIVERY TO TOWN & RURAL

BOB & BEN

THE PETFOOD MEN

WE DELIVER TOWN OR RURAL

www.bobandben.co.nz

PETFOOD HOME DELIVERY

FROZEN

DOG ROLLS

MILK FOR PETS

TREATS & CHEWS

CHOOK FOOD

BIRD SEED

Order online or visit mobile shop at local markets: Mangawhai School, One Tree Point School, Marsden Cove Marina Market.

BOB & BEN

THE PETFOOD MEN

SUPPORT LOCAL. BUY LOCAL

www.bobandben.co.nz | 027 292 4891 | steve@bobandben.co.nz

“Shut the road and be done with it.”

Continued from Page 3

planned road closure enables authorities to prepare detour routes appropriately to accommodate both commuter and freight traffic.” transport costs.

Antoinette said the Road Carriers Association is also asking that a permanent solution bypassing the Brynderwyns be treated as a priority and that construction should start as soon as possible.

“There is nothing to be gained by kicking this can down the proverbial road.”

Anton Trist, Manager Camp Waipu Cove hopes the two-month closure can be put off until after Easter.

He said Easter is a busy time with lots of families coming for a last summer holiday. Some people might come up anyway but others won’t want to risk travelling on the by pass roads.

We had Covid and then all the storms of last summer. We were looking forward to this summer with forecasts that the weather will be fine.

Jennifer and David Rodrigue opened Origin Northland a shop selling mostly locally produced food products in Waipu in August. Do they expect the highway shutdown to impact their new business.

Jennifer said, “Origin Northland stocks local products for locals. That being said, extra business from our visitors over the summer period would be most welcome to help this new business flourish. It is very hard with fresh product to plan for the unknown. We are making investments to be sure to keep our level of service and availability acceptable in peak times, and if we don’t have those peaks due to the road closure, we will have losses. We are putting our faith in the beauty and vibe of Waipu as a destination and the hope that those who want to visit will find a way.”

Hoping this time the road closure will be better organised

People who live alongside State Highway One on the Brynderwyns are hoping the upgrade of the highway will incorporate safety measures to help them turn into the access road to their properties. Seven properties are connected to the access, which is alongside where the 80kmph zone



Log trucks on the south side of the Brynderwyn hill

becomes 100kmph towards the bottom of the northern slope.

The residents say that, although their access is inside the 80kmph zone, the 100kmph sign is only 15 metres to the north and traffic seeing this tends to speed up. What’s more the school bus stops there on the side of the highway to pick up and drop off children.

Suzy Estick said it can be quite frightening turning off the road in her little Ford Fiesta with big log trucks following close behind.

“I have to slow down because its quite a sharp turn and I often get truck drivers leaning on their horns as they go by.”

Paula Gilmore said they are planning a neighbourhood meeting to talk about their common concerns which they will put to Fulton Hogan, the contractor which will be working on the Brynderwyn upgrade. She agrees with Suzy that the turn off is very dangerous and fears that sooner or later there will be a bad accident there.

Since the medium strip barriers went in the residents have been unable o turn right into their road but instead must drive up to the scenic lookout point and turn there.

Tim Dower said, while some of his neighbours have a different view, he thinks this has been a safety improvement but he also has concerns about the 100kmph sign being so close to the access road.

When the highway over the Brynderwyns is closed early next year Tim expects to be give a resident pass to show to road workers so he can get in and out of his property. This is what happened when the Brynderwyns were closed following Cyclone Gabrielle in February. However neither Suzy or Paula were issued with passes and had to argue with road workers to return to their homes. They hope this time around things will be better organised.

The Mayor’s summer message



It’s been a busy year, full of highs and lows, and I think we’re all well overdue a break.

For some the work never stops, regardless of the season and to all of you in that position, I send out heartfelt thanks. No one could fully express how much the work you do and the sacrifices you make are appreciated by the rest of us. Grazie.

To everyone affected by wars and events in other countries, may this season bring some form of peace and relief to you. Let us all care for each other at this time.

Bringing it back home, let’s also be extra caring of our own District this summer. It’s old news that our District has been hit hard this year. It has suffered millions of dollars of damage, with millions of dollars having been invested in repairs so far, and millions more needed over the next few years. Our teams have been working flat out, and with dry weather forecasted over the summer months, the work will continue at pace. While you may notice that there are still some repairs to be made, be assured they are on our lists and we are working solidly through them.

Our teams will get on with programmed works including road building and repairing, and keeping the wastewater systems, freshwater supply and rubbish collections going over the summer. Libraries will still be open and the parks and reserves team will still be caring for places we all enjoy spending time, not to mention looking after coastal assets.

While they are concentrating on all that, you, your family, workmates, neighbours and friends can play an important role caring for our District – you can be our eyes and ears.

Please report any issues you notice as soon as you can. If you notice fly tipping, a water leak, overflowing rubbish bins, damaged signs or a problem with anything else that we look after, call us on 09 4303200 or go onto our website and report it as soon as you can.

We would rather have a dozen people report a broken pipe or a water leak than have it go on for days and get much worse. The quicker we know about a problem the sooner we can get the team onto it, stop things getting worse and sort it all out.

Before you go to the beach, check our website for the rules on dogs, horses, camping and driving. You can find them at www.wdc.govt.nz or call us on 09 430 4200. If you have a problem with noise, animals or anything else, let us know. Use “report it” or Facebook messenger for non-urgent issues. Be proud of our community and report anything that needs our attention.

Remember: if it’s an emergency, please call 111!

Mere Kirihimete koutou, Merry Christmas, happy holidays - and as we would say in my family’s language, Buon Natale e buone feste!

Vince Cocurullo
Mayor, Whangārei District Council

Heartfelt Thank You



Eldon and Leslee Whittaker
Whittakers Funeral Home
25 Kepa Road, Ruakaka.
09 988 9049

On behalf of Leslee and myself, we would like to extend our appreciation to everyone who has embraced us as a new business to this community.

We are so thankful for the support we have received.

We are grateful for all the families who have entrusted us with the privilege of caring for their loved ones. We are inspired by your unwavering strength and devotion.

As we embrace this festive season, our hearts and thoughts are with you and your families.





**STORAGE
BREAM BAY**
Mokohinau Street, Ruakaka, 0116



Shipping Containers

20ft Shipping Containers,
Hire offsite \$180 per month + GST + Delivery
Minimum 3 months,

SPECIAL
1st month free for a minimum 6 month hire
20ft Containers @ Kapa Rd, \$280/m

Enquiries Ph 0212722739 / 021432701
Email: storagebreambay@gmail.com
www.storagebreambay.co.nz



WHITTAKERS

funeral home



09 988 9049

whittakersfunerals.co.nz | admin@whittakersfunerals.co.nz
25 Kapa Road Ruakaka 0171 | PO Box 241 Ruakaka 0151



**BREAM BAY
STORAGE**

INSIDE/OUTSIDE storage at 50 Cove Rd., Waipu

Free phone. 0800 432 135
enquiry@breambaystorage.co.nz

www.breambaystorage.co.nz



**RUAKAKA
SAFE
STORAGE**

99 MARSDEN PT ROAD, RUAKAKA
92 Units from 6 x 3 to 1 x 1
Each unit individually alarmed and monitored
Electrified security fence

Ph. 0508 273 262 or 0275 310 788
CLEAN - DRY - SECURE

Cricket in the Caledonian Park



Ruth and Murray Gillingham were at the Caledonain Park on Saturday 2 December 2023 to watch thier son Dean bowl for Waipu in a match against Tomorata. This was the first match played in the park since the Bream Bay team relocated there from Bream Bay College. The move revives an old tradition as cricket predates rugby in Waipu with the first Waipu cricket club formed in 1870. The first record of cricket being played in the Caledonian Park is an item in the Northern Advocate on 1 April 1899. Saturday's game was won by Tomarata with Bream Bay fallins short by 36 runs in the 40th over. The next game will be played against Maungakaramema this Saturday 9 December, once again in the Waipu Caledonian Park.

Ruakākā Wellness Centre on schedule to be completed by next April

The Ruakākā Recreation Centre is applying to the Whangārei District Council for an increase in its operating grant as once the currently under construction Wellness Centre is open it will be operating from two buildings. Christine Thirling who is the manager of the Recreation Centre said another person would need to be employed and there will be maintenance costs for two buildings. Christine said there are costs that just can't be cut back on such as insurance, which has gone up from \$4,500 to \$13,000 in the past few years. There is also an annual fire safety audit, as well electricity, water and maintenance costs. The Recreation Centre currently gets an annual grant of \$46,000 per year and Christine said even with the money earned from gym fees, rental from the adjacent former childcare building and hall and

meeting room hire it's a tight fit. She said it would be help if groups, which use the centre, could write letters of support to the Council. Paul MacDonald, the Wellness Centre project manager said construction the \$5 million project is progressing well with the roof in place and wall cladding underway. There was a two- week hold for the steel wall cladding to arrive but the construction team was able to work on other parts of the build so this didn't have too much impact. The Wellness Centre will have 888 square metres of floor space or 1200 including a deck which will be built on the North side with a view out to Mt. Manaia. The completion date is still next April although Christine said it might take some time to set up the new gym. She has nightmares about moving all that heavy equipment across but has had of offers of help from gym users.





**ADVANCED
EARTHWORKS**
we create your future

**We Specialise in Civil and Siteworks in
the Whangarei-Ruakaka-Waipu-Kaipara Areas**
P: 021 198 8288 E: arne@advancedearthworks.co.nz



The next stage of Waipu to Waipu Cove Cycle and Walkway

Work is about to begin on the next stage of the Waipu to Waipu Cove Cycle and Walkway. This will take the trail from the McLean Rd corner to approximately 250m along the straight approaching the Waipu Cemetery. The trail will cross Cove Rd. at this location, where there is good visibility and will continue along the estuary side of the road.

The required easements have been agreed with most in place, spraying has been carried out in preparation and it is hoped contractor Paul Jenkins will be able to get to work there after Christmas.

The Waipu to Waipu Cove Cycle and Walkway Group has funds to the tune of \$130,000 in hand but will need more to build the trail all the way to the cemetery and is working on a range of funding options to plug this shortfall. Cycle/Walkway Trusts Chairman Tim Manning said, “We should have a more accurate idea of how much more is needed once the first 250metre section is completed.”

The Whangārei District Council had committed to building the final section of trail from the cemetery to link with the three kilometres of established trail from Waipu town running alongside the Flagstaff Terrace subdivision. This will involve finding space around the tight corner alongside Riverview Place. The sum of \$600,000 was set aside for this work in the 2023/2024 year of the Council’s current Long Term Plan, however, the cycleway group has recently been informed that \$300,000 has been taken from this budget to use to repair storm damaged roads and will need to be re-approved in the new 2024 -2034 Long Term Plan. Public submissions on the 2024 – 2034 Long Term Plan will begin in March.

Pool open for the summer

The Bream Bay College 25 metre swimming pool is once again open to the public this summer on weekends from 10am to 5pm and next week from Monday 11 December it will be open weekdays from 11am to 6pm.

Paid lifeguards will be in attendance and swimmers are asked for a gold coin donation. CLM (Community Leisure Management), the company that runs Whangārei’s Aquatic Centre, will be managing the pool for public use over the summer holiday period with funds provided by the Lotteries Commission

As seen on Grand Designs 2019

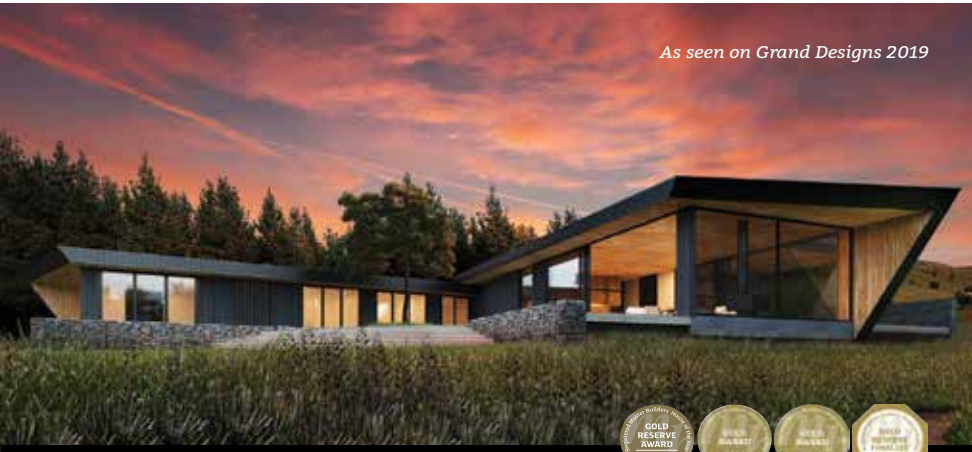

COASTAL CONSTRUCTION PROJECTS

0274 320 007

REGISTERED MASTER BUILDER QUALIFIED TRADESMAN CARPENTERS MARCUS@CCP.NZ WWW.CCP.CO.NZ

An Almost Traditional Christmas Carol Service

Come along and sing some great old Carols, listen to the Christmas story once again, and reflect on the meaning of one who came as a baby

Sunday December 17 @ 8.30 pm
supper served afterward

Waipu Presbyterian Church
50 The Centre, Waipu

This is a Community event
All Welcome



Join us for the Ray White Bream Bay & Waipu Family Picnic Challenge!

In conjunction with Parafed Northland

Family Picnic Challenge

—•Connecting Communities•—

Marsden Cove Marina DECEMBER 9TH

\$20
Per Family Team!

new start time!

Proudly Supporting
Parafed Northland
INCLUSIVE SPORT & RECREATION FOR ALL NORTHLANDERS

RayWhite
BREAM BAY



Limited Entries! To register visit www.parafednorthland.com

An inclusive fun family event where the whole family can enjoy a day out together.

The challenge follows the footpath around Marsden Cove Marina and along the course, participants need to complete different challenges to move on. Finish the challenge with a picnic at the Marina.

When: Saturday 9th December
Time: 12:30 pm Start
Where: Marsden Cove Marina
Cost: \$20 per family team (Max 2 adults & 4 children)
Register through our website here:
<https://www.parafednorthland.com/programs-and-events>

Don't forget to register for our local fun day out! Spaces are filling quickly with limited entries. Guaranteed to be a great day out for the whole family and an awesome way to connect with other local families whilst having some fun. Cool challenges and prizes.

The Villy Day Out, celebrating the people of Ruakākā

Photos by Peter Grant



Sophia George, aged 11 from Ruakaka, taking part in a fire fighting challenge with the Ruakākā Fire Brigade



Alexis Morley, aged 7, of Ruakākā trying out her building skills at one of the many activity stalls for children.

MARSDEN POINT HIGH TIDES				
	AM		PM	
Thu 7 Dec	3.25	2.1	3.47	2.3
Fri 8 Dec	4.22	2.1	4.36	2.3
Sat 9 Dec	5.19	2.2	5.26	2.3
Sun 10 Dec	6.13	2.3	6.15	2.3
Mon 11 Dec	7.03	2.3	7.04	2.4
Tue 12 Dec	7.50	2.5	7.53	2.4
Wed 13 Dec	8.37	2.6	8.43	2.5
Thu 14 Dec	9.23	2.6	9.32	2.5
Fri 15 Dec	10.10	2.7	10.22	2.6
Sat 16 Dec	10.58	2.7	11.13	2.6
Sun 17 Dec	11.48	2.7	~	~
Mon 18 Dec	12.05	2.5	12.39	2.7
Tue 19 Dec	12.58	2.5	1.32	2.7
Wed 20 Dec	1.54	2.5	2.27	2.6
Thu 21 Dec	2.54	2.4	3.23	2.6
Fri 22 Dec	3.56	2.4	4.20	2.5



Despite wet weather the crowd turned up to the Villy Day Out in the Ruakaka Sports Park on Saturday 18 November. The popular event, for and by the people of Ruakākā, returned after a two year forced break due to the Covid 19 pandemic

MAGIC TYRES

Large selection of used & new tyres

Car & Trailer Rims

Ph. 438 3534

103 Port Rd., Whangarei



The Professionals, a group of amateur musicians who practice together at the Bream Bay Community Trust. The group's motto is "if in doubt play C."

Rain couldn't dampen the spirit of the Villy Day Out held at the Ruakākā sports grounds on Saturday 22 November. Organiser Bobby Joe Paikea estimates over 1,000 people turned up and there were over 50 stalls including stands by many service providers.

This was the third time the event has been held, after being cancelled for the last two years due to Covid 19.

The Villy Day out is run for and by the Ruakaka community with free activities and give-aways, including a hangi for 400 people by the Pumipi family. There were kapahaka performances from local schools and a ukulele group which practices together at the Bream Bay Community Support Trust had a spot on the stage.

"It's all for love, coming together to celebrate the community", said Bobby Joe.

Bream Bay Garden Maintenance

Landscaping • Planting • Raised Beds
Decks • Hedges trimmed • Trees pruned
Weed control • Section Tidy Up
• Simple Building jobs•

Free Quotes

NO JOB TOO SMALL

One Offs, Weekly, Fortnightly or Monthly

Phone Marcus 021 343 727



north haven
hospice
Te Korowai Humarie

MANGAWHAI OPENING!!

North Haven Hospice is opening their new Mangawhai Charity shop with all proceeds going directly to the communities we care for.

WEDNESDAY 13 DECEMBER 2023

Opening hours will be:

Tuesday to Friday 9.30am to 4.00pm

Saturday 9.30am to 3.00pm

41C Moir Street Shopping Centre

T: 09 431 9091



Want more from your learning?

**We help you go
far in your career
while staying close to
home.**

At NorthTec | Te Pūkenga we bring the learning to you by offering local, region-specific training right here in Te Tai Tokerau.

If you want to train towards a trade, get qualified in a new career, or even just upskill yourself for your current industry then we have what you need. We have options for on-campus, online, or on-the-job learning to suit your needs and goals.

We offer full-time, part-time, and even paper-by-paper study right here in Northland with options for certificates, diplomas, degrees, and even short courses. That way you can achieve your goals and work towards your dream career without having to travel long distances or leave home.

Go far in your job, while staying close to home by learning with us at NorthTec | Te Pūkenga.

Enrolling now for 2024.

0800 162 100
northtec.ac.nz



Waipu writers feature in new Northland anthology

By Melinda Butt

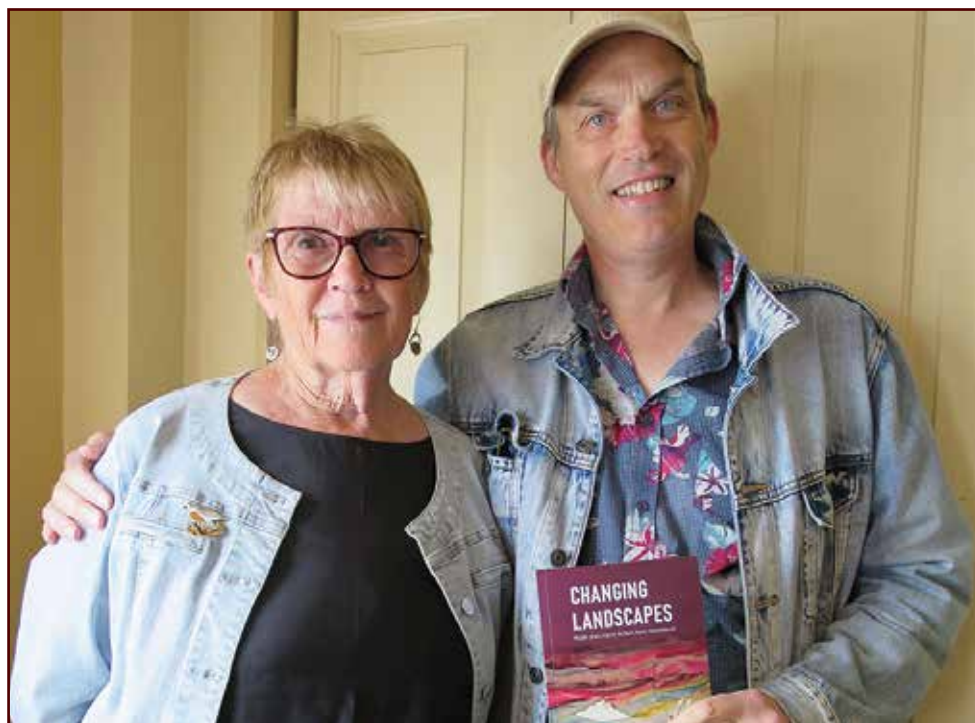

Eddie Williams and Sue Barker

Eddie Williams and Sue Barker from Waipu celebrated their contribution to the launch of a new anthology of Northland authors titled 'Changing Landscapes.' The launch was held at the Dickens Inn, Whangārei on Saturday the 25th November. Participating writers, young and old attended the event with many reading their submissions to the crowd.

Sue Barker is a flash fiction and poetry writer has been involved with the Whangārei Library's Flash Fiction group for five years. Passionate about supporting aspiring writers she is a key member of the group. *Changing landscapes* "was a way to support and express ourselves through a challenging year" she said.

Sue writes all short form fiction and some poetry. She won the 2020 Whangārei Library Flash Fiction Competition and has been published in Fast Fibres Poetry 9 and 10. She co-edited and contributed to *You Might Want to Read This*, an anthology of Whangārei Library Flash writers in 2021.

Eddie Williams has been writing all of his life. He originally started with song writing, which then evolved into a broader scope of expression. In 2021 he self-published his debut novel, *A Volatile Mixtape*, a young adult fiction which he said was inspired by his 'misspent youth'. Eddie is a NZ society of authors Northland Branch short story competition winner and has previously had two flash fiction stories published in *You Might Want to Read This*.

Another Waipu writer, Jan Haraldsson also contributed to the Changing Landscape book but was unable to attend the event.

The inspiration behind the Changing Landscape anthology was a response to the multiple weather events we have all experienced. After a year of ongoing downpours the Whangārei Library's Flash Fiction group used the unprecedented bad weather as an impetus to create. The group called for submissions with a theme of 'our many and varied changing landscapes, from climate change and natural disasters to life, family and relationship shifts, the approach was broad and imaginative. The eclectic mix of flash and micro fiction reflects Northland's local talent from writers young and old, and with a grant funded by Creative Communities this collection could be published and now purchased.

The anthology includes stories from 35 different writers, and stories are no longer than 300 words. If you are interested in reading and supporting our local writers you can purchase the book from whangareilibrary3.30flash@gmail.com or contact Sue Barker on 027 281 8829.



- ❖ Chemical and non-chemical house washing
- ❖ Window and house cleaning
- ❖ Painting and staining – exterior house, decking and fences
- ❖ Water blasting - decks, driveways and courtyards
- ❖ Clean guttering and downpipes
- ❖ Pest control and spider spraying
- ❖ Tree trimming with extension saw

Phone now for a **FREE QUOTE**

REVITALISE ❖ PRESERVE ❖ PROLONG ❖ MAINTAIN

TONY 021 196 2949 OR MELISA 021 075 6770

Phone the BREAM BAY NEWS - 09 432 0209

or email: breambaynews@xtra.co.nz

if you know of something interesting going on in Bream Bay.

Love getting paid for dressing up?...

Brought to you by **Promote Waipu**

...then you'll Love the Waipu Christmas Parade!

We'd love you and your team to be part of our hugely popular Christmas Eve Street Parade. We invite clubs and groups from the wider Bream Bay area to join us and be in to win in the 'best dressed float' competition. The festivities start at 7pm on December 24 and finish with prizegiving at Waipu's Caledonian Park at 7.30pm.

Over \$2000 of prizes to be won - register your float now!

To register contact Penny Reynders (021) 530803 or secretary@promotewaipu.co.nz

Love being active?

24/7 gym

- no lock in contract,
- no admin, no joining fee
- \$10 per week
- Ladies only gym
- Unisex gym
- Casual gym \$2 per day

Come and join us at the Ruakaka Recreation Centre

Lounge available for hire - up to 134people
Meeting room for hire - up to 15 people
For events kitchen facility available

Very reasonable rates

9 Takutai Place
Ruakaka
Ph: 432 7962

Opening hours:
Mon, Tues, Wed, Fri
8am to 2pm
Thur 8am to 6pm

Activity	Day and Time	Cost	Contact
Fit for life Ruakaka class	Monday 10am to 11am		\$5 AnnMarie 0211693115
Fit for life Ruakaka class	Wednesday 11am to 12pm		\$5 AnnMarie 0211693115
Preschool gymnastic classes	Tuesday 10.45am-11.30am	\$10 per session	Nadine 029 776 7754
homeschool gymnastic classes	Tuesday 11.45am-12.45pm,	\$15 per session	Nadine 029 776 7754
Preschool gymnastic classes	Thursday 2pm - 2.45pm	\$10 per session	Nadine 029 776 7754
Recreational gymnastics	Thursday 3pm - 3.45pm, 4pm - 4.45pm for 5-8 years	\$15 per session	Nadine 029 776 7754
Recreational gymnastics	Thursday 5pm - 6pm for 8 years +	\$15 per session	Nadine 029 776 7754
Zumba Gold	Tuesday 9am to 9.45 am		\$7 Rozrozhzumba@gmail.com
Zumba Gold	Thursday 9.30am to 10.15am		\$7 Rozrozhzumba@gmail.com
Stretching classes	Thursdays 11am to 12pm		\$5 Lu 4328941
60's up	4th Friday of month 10am to 4pm	\$12 annually fee	Joy 021491887
petanque or indoor bowling	Wednesday 1pm to 4pm		Sue 021850286
Music club	1st Monday of month 7pm to 10pm		\$5 Fulco 0274718428
Zumba	Monday 8.45am to 9.45am		\$8 Janine 021437840
Zumba	Wednesday 5.45pm to 6.45pm		\$8 Janine 021437840
Zumba	Friday 4.45pm to 5.45pm		\$8 Janine 021437840
casual gym	Monday to Friday 8am to 2pm	\$2 per day	Christine 4327962
casual Squash	Monday to Friday 8am to 1pm	\$5 per hour	Christine 4327962

We are also home to Bream Bay Squash club and Bream Bay United Association Football club

Waipu Tennis update

By Paul Ramsay

Club nights continue with 36 people plus a few reserves out having fun. Tuesday is our busy night with Juniors and Intermediates starting at 3pm and the Senior Social night at 6.00pm. Current leaders are Team 7 (Dayle Widdup, Stuart Abercrombie, Brent Rice and Jo Reid) with 17 wins. Team 5 (Sean McCombe, Simon Townsend, Gary Prohm and Ebony Antony-Conner) are close behind on 16 wins with just two games to go. The pre-Christmas season finishes on 18 December.

Waipu ITM sponsored some paint and building materials that allowed Margaret, Paul and David to spruce up the clubhouse a bit.

Bragging rights in A grade interclub go to Waipu Gold who beat Waipu Silver 4-2. Waipu Gold continued their winning streak beating Keri Keri Aces 5-1 but then fell heavily to Mairtown Megatrons 6-0. Meantime Waipu Silver have yet to win a match losing to Keri Keri Deuces 5-1. Waipu Bronze had to default a game postponed by rain but have played two more games since drawing with Mairtown Angels but losing on countback 50-49. A good win 4-2 over Kamo Kings followed.

Tennis starts again on 16 January for hit ups. The social nights will start in February as will the Sawmill competition on Thursday nights. The Sawmill competition is open to everyone so get a team of four together and your entry to Sean or Steve.

Our One Set Wonder doubles tournament is on 17 February with a 10am start. The tournament is graded into A and B grades and there are around \$800 in prizes on the day for winners, runners up and lucky draws. The tournament is open to everyone. Text your entries to Paul (0274416542) by 14 February.

It is never too late to come along to tennis as we are always looking for people to fill in when someone is away or injured.

Remember to check our Facebook page for what is going on at the club.

BREAM BAY link

EVERY THURSDAY



OPERATED BY
LEABOURN
Ph: 0800 994 404
E: office@leabourn.co.nz

MORNING		
9.00am	Departs	Kaiwaka Kaiwaka Hall
9.15am	Departs	Mangawhai Village Village Shops Bus Stop (by restrooms)
9.20am	Departs	Mangawhai Heads I-Site
9.35am	Departs	Langs Beach Corner of Wairahi and Cove Roads
9.40am	Departs	Waipu Cove Beach Car park
9.50am	Departs	Waipu Monument Bus stop
10.10am	Departs	Ruakākā Peter Snell Road (opposite Takutai Place)
10.50am	Arrives	Whangārei Rose Street Bus Terminus

*For travel within Whangārei see CityLink Whangārei timetable
www.citylinkwhangarei.co.nz
or get your timetable from the Rose Street office.

AFTERNOON		
3.00pm	Departs	Whangārei Rose Street Bus Terminus
3.40pm	Departs	Ruakākā Peter Snell Road (opposite Takutai Place)
4.00pm	Departs	Waipu Monument Bus stop
4.10pm	Departs	Waipu Cove Beach Car park
4.15pm	Departs	Langs Beach Corner of Wairahi and Cove Roads
4.30pm	Departs	Mangawhai Heads I-Site
4.35pm	Departs	Mangawhai Village Village Shops Bus Stop (by restrooms)
4.50pm	Arrives	Kaiwaka Kaiwaka Hall

ROUTE DESCRIPTION
Kaiwaka/Mangawhai Road, Molesworth Road, Mangawhai Heads Road, Cove Road, The Centre Waipu, Nova Scotia Drive, SH1, Marsden Point Road, Peter Snell Road, Marsden Point Road, SH15A, SH1, Otaika Road, Maunu Road, Walton Street, Rose Street Bus Terminal.

If you would like to be picked up elsewhere along the route, please phone Leabourn's to arrange this on the Wednesday before you want to travel.

CONTRACTED TO:
Northland REGIONAL COUNCIL
Te Kaitiaki o Te Tai Tokerau

For service updates visit:
www.buslink.co.nz
Feedback to buslink@nrc.govt.nz

- # WHAT'S ON IN BREAM BAY
- **RUAKAKA CHRISTMAS PARADE** Saturday 9 December. Starts at 10.30am alongside the Ruakaka Recreation Centre. After the parade Christmas Carols, facepainting, sausage sizzle, quick fire raffles and funny money to spent in the Ruakaka Towncentre.
 - **RAYWHITE BREAM BAY FAMILY PICNIC CHALLENGE.**Saturday 9 December at the Marsdn Cove Marina. Start time 12.30pm. \$20 per family. Family challenges with prizes.
 - **WAIPU BOUTIQUE SUNDAY MARKET** Next on Sunday 10 December . From 9am to 1pm in the Coronation Hall
 - **MARSDEN COVE CHRISTMAS MARKET** Sunday 17 December. 9.30 -2pm at the Marsden Cove Marina
 - **ONE TREE POINT ARTISAN MARKET** Next on Sunday 17 Decembervember Fundraising for Whangārei Hospital Children’s Ward. Sunday 18 June from 9am-1pm. One Tree Point School quadrant and field. Free Santa photos
 - **CAROLS AT LIFEPOINT** Sunday 17 December. Free dinner from 5pm. Music from 6pm. 300 One Tree Point Rd.
 - **CHRISTMAS CAROL SERVICE AT THE WAIPU PRESBYTERIAN CHURCH,** 50 The Centre, Waipu. Sunday December 17 at 8.30pm. Supper served afterwards
 - **WAIPU CHRISTMAS PARADE. BACK ON CHRISTMAS EVE.** Sunday 24 December starting at 7pm by the Pizza Barn in Cove Rd., Waipu. Finishing with a prizegiving in the Caledonain Park at 7.30pm. Organised by Promote Waipu.
 - **WAIPU MUSEUM** 36, The Centre, Waipu. Open seven days 10am-4pm .
 - **THE KAURI MUSUEM.** . The Kauri Museum is open 9am-5pm every day except Christmas Day. 5 Church St., Matakoho. See more at www.kaurimuseum.com

Gelato in Waipu



Hannah Engelman Little Lato founder with understudy Stella Murray (third from left) and local gelato scoopers Georgia Moodie and Ava Mewett

There is a pop up gelato shop here for the summer in the old bank building opposite the Pizza Barn in Waipu. This is the latest venture of gelato queen Hannah Engelman who founded the company Little Lato

Hannah previously worked for Fonterra and won a scholarship to study gelato making in Italy where there is a university dedicated to this art form. In 2017 she established a gelato-making kitchen on Auckland's North Shore, which now churns out many litres of gelato in multiple and often innovative flavours and supplies outlets in Auckland and around New Zealand.

Little Lato recently opened its first parlour in Hamilton and now this one in Waipu. Last Saturday Stella Murray, a food technology student and one of Hannah's protégées, as well as local girls Georgia Moodie and Ava Mewett, who have holiday jobs scooping gelato were in the Waipu parlour with Hannah. On offer were 20 different gelato flavours with dairy and non-dairy options.

**Phone the BREAM BAY NEWS 027 432 0070
or email:breambaynews@xtra.co.nz
if you know of something interesting going on
in Bream Bay.**



More homes for Ruakākā community drop-in opportunities

Please join us at our community drop-in day or one of our drop-in sessions in December to find out more about our plans for new homes in Ruakākā, meet the team and ask questions.

Drop-in day:

Date: Thursday 7 December
Time: 10am - 6pm (drop in anytime)
Location: Bream Bay Trust Hall,
9 Takutai Place, Ruakākā

Drop-in sessions:

Date: Thursday 14 & 21 December
Time: 9am - 10.30am (drop in anytime)
Location: Room 4, Bream Bay Trust,
9 Takutai Place, Ruakākā

Nau mai, haere mai – we look forward to seeing you.



WAIPU LOTTO & POST



Lotto
Postshop
Photocopying

Emailing
Newsagents
All stationery needs



The Centre, Waipu

Phone 432 0900

TRADES & SERVICE DIRECTORY Ph 09 432 0209

**LAWSON
CARTAGE**
FOR ALL YOUR
EARTHWORKS & CARTAGE NEEDS
*Suppliers of: topsoil, compost, woodchip,
bark, sand, pebble, rocks and firewood.*
Ph/Fax 09 432 8418 or 021 768 940
458 Marsden Point Rd. PO Box 142, Ruakaka 0151
email: lawsoncartage@xtra.co.nz

**BREAM BAY
ACCOMMODATION**
RUAKAKA
STUDIO - HOLIDAY HOMES - B&B
BOOK ONLINE OR PHONE
Ph: 09 432 7025 Mob: 021 2722 739
website for online bookings: www.breambayaccommodation.com

WORTHY AG

SMALL BLOCK MULCHING
Phone COLIN (Joe) 0274916983

**Bream
Bay
Tax**
Tax
Accounting
Business support
Free first consult.
Fixed price packages
Supporting Bream Bay businesses
Robb MacKinlay 027 540 7859
robb@breambaytax.nz www.breambaytax.nz

**BARFOOT
THOMPSON &**
I Love Selling Bream Bay!
Angelique Hartnett
Coastal & Lifestyle Sales / AREINZ
0274 356 411 / 09 435 5914 P
a.hartnett@barfoot.co.nz E

**This Space
Now available**
**\$42.80 gst inclusive
or for regular customers
(six or more insertions)**
\$38.50 gst inclusive

TRADES & SERVICE DIRECTORY

Ph 09 432 0209

NORM FAGG
OWNER / OPERATOR

Act Now
Car Rentals

M: 0274 362 480
Nz Freephone: 0800 362 480
E: info@actnowrentals.co.nz

From \$45 per day - Min 4 days
Based in Ruakākā

Ph: 09 432 0123

BREAM BAY GLASS

FOR ALL YOUR GLASS NEEDS



Mob: 0274954548

AMG
AUTO MOBILE GLASS

FAST WINDSCREEN REPLACEMENTS & CHIP REPAIRS

- Mobile service or come to our workshop
- Ultra competitive pricing • Insurance claims welcome.
- Windscreen replacement in under an hour.

Phone Conrad on 022 036 2916
2/17 Gumdigger place.

BRADLEY
EARTHWORKS

• POND CLEANING • DRIVEWAYS • RACEWAYS
• LAND CLEARING • TREE REMOVAL • ROADING AND MORE!

CALL ME TODAY FOR ALL YOUR EARTH & TREE WORKS
PHONE ROY 027 374 5090 WAIPU

ABSOLUTE CONCRETE

www.absoluteconcrete.co.nz

CULVERT PIPES
Spun and reinforced
Crane truck delivery
Drainage Merchant - Hardware Store
Email: sales@absoluteconcrete.co.nz
Phone (09) 431 2211
KAIWAKA

MACSWAY
SCAFFOLDING LTD

WE BUILD, HIRE, ALLOY MOBILES, TEMPORARY FENCING, & SHRINKWRAP

Ph: 09 432 7643 • 0274 726 772
macsway@xtra.co.nz Kepa Road, Ruakaka

O'MALLEY CONTRACTING LTD | CONCRETE SPECIALISTS

- FOUNDATIONS
- HOUSE SLABS | STAIRS
- RETAINING WALLS
- DRIVEWAYS | CARPARKS
- EXPOSED AGGREGATE
- COLOURED CONCRETE
- COMMERCIAL | RESIDENTIAL
- LICENCED BUILDING PRACTITIONER

Free No Obligation Quote

FAMILY OWNED & OPERATED

021 2200 198 | OMALLEYCONTRACTING.COM

Bream Bay Concrete Ltd.

Free Quotes • Reliable Service • Quality workmanship

- Concrete pads
- Shed floors
- Pathways
- Home floors
- Driveways
- Concrete cutting
- Excavation works
- Retaining walls
- Paling fences
- Profiles for homes & sheds
- Subfloors & boxing

Mark Royals Ph: 432 0107 Mob: 0274 433 130

BREAM BAY ELECTRICAL

Wiring Safe Homes And Businesses Throughout Northland

RESIDENTIAL COMMERCIAL INDUSTRIAL

0800 223 555 • 027 35 33 555
www.breambayelectrical.co.nz

24H SERVICE

BAYSIDE CONTRACTORS

RESIDENTIAL EARTHWORKS • HOUSE SITES
DRIVEWAYS • TRENCHING & DRILLING

Contact Shane 027 3019 480
admin@baysidecontractors.co.nz

TC ENGINEERING
Metalwork Specialists

Stainless and Aluminium Welding and Bespoke Fabrication



Gates and outdoor furniture. Marine repairs and fabrication.
Onsite welding for farm repairs and modifications.
www.tcengineering.nz 021 145 7075 or 021 203 0309

Tractor Mulching

100hp tractor with high bodied yffails, mulcher, park finishing mowers, slashing
Gorse & blackberry spraying

Also mechanical tractor repairs

Phone Bain McGregor
0274 979 013
or 09 432 0527



Grant McLean
Stock Agent for Bream Bay

Ph 021 7758 48
Email: skincarla@xtra.co.nz

All aspects of stock sales including:
• dairy beef • bobby calves • store cattle • live export heifers
• sheep • pigs • supplying stock for slaughter

Also caters for small block holders.

Carrfields Livestock

Ruakaka Motors

Mechanical and Auto Electrical Repairs and Servicing

Monday - Friday 7.30am - 5pm

Tyres and Batteries
Warrant of Fitness testing
Phone 432 7233

PARADISE QUARRY

PARADISE QUARRY STONEMASONS
Specialists in stunning stone for landscape
Suppliers & installers of northland's own schist for all your stonemasonry & landscaping Requirements

(09) 432 2722 or GEOFF (021) 972 139
www.paradisequarry.com

SUSAN JACOBS PAINTING
INTERIOR • EXTERIOR
027 370 5339

BLIND PRO

Blinds • Awnings • Shutters

Indoor blinds and outdoor screens

Call us today for a free, no obligation consultation and quote

ph 09 423 9661
website www.blindpro.co.nz
email info@blindpro.co.nz

McQUINN PUMPS

How's Business? ... It's Pumping!

24/7 SALES, SERVICE & INSTALLATION | PUMPS & WATER TREATMENT
PHONE SUPPORT AVAILABLE

0800 627 846
PHONE FREE

NOW AT 72 KIOREROA ROAD
—ALONG FROM RD1 & ITM

Deadline for next issue - Wednesday 13 December

TRADES & SERVICE DIRECTORY **Ph 09 432 0209**



HANSEN
Drainage & Earthworks

DRAINAGE:
* Septic Systems * Water Tanks * Truck & Digger Hire *
* Subdivisions * Domestic * Commercial *
Certifying Drainlayers

Licensed Contractor for
Waste & Drainage Work



EARTHWORKS:
* Subdivisions *
* Farm Work: Effluent Pond Design & Build, Dams, Races *
* House Sites * Driveway Prep * Lawns * Roading *

P. 09 432-7877 M. 027-432-7877
E. karl@hansende.co.nz



Team James Alexander

JAMES ALEXANDER
021 878 178
SALESPERSON & AUCTIONEER

ASHLEIGH LOUISE
027 733 5703
SALES ASSOCIATE

Licensee Salesperson, The Real Estate Shop Limited, Licensed (REAA 2008)

Small Building Jobs & Repairs

- Letterboxes • Curtains • Smoke alarms,
- Clothesline • Decks • Fences,
- Kitchen and bathroom repairs
- Rental property maintenance

Call Tony on 021 196 2949

**Local people read
THE BREAM BAY NEWS
It is an effective
place to advertise**

GREEN DESIGN LTD
ARCHITECTURAL DESIGN SERVICES

*Focusing on
Sustainability & Energy Efficiency*

Contact Simon
Mob: 021 2845 095
simon_duffy00@hotmail.com | www.greenbulddesign.co.nz

Long Run Roofing & Cladding
Re-roofing & Spouting
Edge Protection



Terry Mounsey
021 562 269
wetaroofing@xtra.co.nz

**RELIABLE &
PROFESSIONAL SERVICE**

**STORAGE
BREAM BAY**
76 Waiwarawara Dr, Ruakaka 0171

Karen Loft
Business Manager
Mob: 021 432 701

Office Hours 9.00 - 1.00
email: storagebreambay@gmail.com
www.storagebreambay.co.nz

LOW COST DRIVEWAYS & SURFACING NEEDS

Concrete or asphalt beyond your budget ...

We have the next best solution for a fraction of the price.

Call for a quote, you'll be pleased you did!

Paradise Quarry Contractors

Geoff (021) 972 139 or (09) 432 2722

For contractors who 'think' ...

Hydroseeding

**Spray On
Lush Lawns**



For a free consultaion & quote, call or email
George 021 688 949
Info@gogreenteam.co.nz

**MPP
MARSDEN
PANEL & PAINT**

Panelbeating and Spraypainting
Caravan and Motorhome Repairs
Tyres New and Secondhand
Punctures

470 Marsden Point Rd, Ruakaka
Call 09 4330313 24 Hrs or Bert 021 983 724

M.V.B. Electrical Ltd.

Working in Bream Bay since 1977

Repairs • Installations • Advice

Mike van Blommestein

Phone: 09 432 1015 • Mobile: 0274 783 749

Email: mikevanb@xtra.co.nz

**BLINDS
SHUTTERS
& CURTAINS**
Bream Bay Whangarei & Districts

Rollers, Venetians, Verticals
Shutters, Curtains & Outdoor Blinds



Ask about our DISCOUNT for houselots
Free in-home measure & quote
Free Installation

Phone Gail 0211 95 35 35

www.blindsandshutters.co.nz

**GRAEME BINT
FENCING**

GOOD RATES, NO JOB TOO SMALL

**09 432-1599 or
027-292-2833**

grbint@xtra.co.nz

MANGAWHAI SMALL ENGINES

Grasshopper, Husqvarna and Honda dealer



194 Molesworth Drive, Mangawhai
Ph: 09 431 5270 or Mb: 021 655 481

Email: msengines@xtra.co.nz

BREAM BAY HYDRAULICS

Bream Bay's first local
hydraulic hose service



021 308 358 breambayengineering@gmail.com

BREAM BAY NEWS PHONE 09 432 0209

Email: breambaynews@xtra.co.nz

Post copy to : Bream Bay News, RD 2, Waipu
Email: breambaynews@xtra.co.nz
or leave it at the Waipu or Ruakaka Post and Lotto Shops

FOR SALE

WATER TANKS

09 431 2211
sales@absoluteconcrete.co.nz

RAWLEIGH'S PRODUCTS Independent dealer. Ointments back in stock. Phone Susan McRae 027 227 2291.

WORMS FOR SALE
For worm farms
Phone 432 0209
or text 027 432 0070

Scooters Plywood
3mtr Scaffold Planks \$77
12mm H3.2 NS Plywood \$79.00
Ph 438 6565

WILTSHIRE SHEEP
Ideal lifestyle block sheep
Self Shedding
Ph 027 432 1016

 **seniornet**
Confidently connecting with technology

2024 CALENDARS Selling Fast!!!



DON'T MISS A GOOD OPPORTUNITY
Scenic images of Bream Bay. ONLY \$10
Ideal gift, includes envelope ready for posting.
LIMITED NUMBERS AVAILABLE NOW AT -
Ray White Real Estate Waipu;
Westpac Bank, Ruakaka; SeniorNet
DON'T delay in purchasing yours
Please support our SeniorNet annual fundraiser

CLASSIFIED ADVERTISING

Costs \$5.50 for up to 20 words and 20c for each additional word.

Boxed, classified adverts cost \$16.50 gst .inc.

Phone your advert through to 432 -0209

email it to breambaynews@xtra.co.nz

Post to: Bream Bay News, RD 2 Waipu 0582

or leave it with payment at The Waipu Post Shop or the Ruakākā Gift and Lotto Shop

SERVICES OFFERED

NORTHLAND HEADSTONES

Located in One Tree Point
Your Local Headstone Showroom
Call 0800 707 800
www.northlandheadstones.co.nz

Tree Removal
✓ Pruning
✓ Chipping
✓ Stump grinding
Qualified & Insured
Ph Scott (0800) 468-9663
Arborcare Tree Maintenance

PHOTOGRAPHER AVAILABLE. Waipu, Commercial, real estate, weddings, documentary, aerial, drones, events. Ph: 021 139 2553.
EIGHTYTHREEPHOTO.COM

Waipu Boarding Cattery

Excellent care and accommodation
Ph Sue 432 0394



WATER TANK CLEANING

No need to empty your tank

- Vacuum or full scrub
- Phone Mark Draper
0274 707 607

JD LAWN CARE SERVICES PH. 021 063 7907

Lawn mowing, Weed spraying, Water blasting, surface cleaning of driveways, paths and patios, Hedge trimming, Section clearing, tree pruning, wood chipping and more.

SOCIAL SERVICES



LINKING HANDS
Health Shuttle
Phone (09) 431 8969



Not sure? Ask us!

We provide free, confidential and independent information and advice to help you understand your rights and responsibilities.

Contact us for assistance.
09 438 8046 • whangarei@cab.org.nz

www.cab.org.nz

BREAM BAY ANGLICAN FOODBANK

If you would like assistance or know someone that does, perhaps we can help
Please phone Janet 433 0045
Or Anoek 021 141 3409

SOCIAL SERVICES



Safeman Safe family Men's Centre

Safeman Safefamily offers a safe place for men to talk privately without judgement and with complete confidentiality. We are peer led and professionally supported and offer a range of services and support for men and their families.

The services we provide are as follows:

- Advocacy Navigator
- Court support
- FGC Support
- Probation Community Service Provider
- Legal Advice
- Marriage Celebrant
- House and property blessing
- One to one counselling
- Drug and Alcohol support
- Anger management group sessions
- Supervisor for court ordered access
- Work brokers/ help with employment opportunities.

No appointments are necessary, we have an open door policeu - if you need help or know someone that does just come on down to: **9 Takutai Place, Ruakākā**. We are right next door to Jimmy's Barber Shop or I can be reached by phone 021 121 0763 - Phil Paikea

Bream Bay Community Support Trust



Takutai Place, Ruakaka Phone: 09 432 7197

Services we provide:

- Registered Social Workers
- Family Support Workers
- Youth Workers
- Youth Hangout Space (watch this space...)
- Community Connectors (Connecting community to various services)
- Free Whanau Ora Medical Clinic with Ki A Ora Ngatiwai. Wednesday mornings 10am-12noon, by appointment only phone 09 435 4586
- Free Budgeting Service – Tuesdays 10am-12pm by appointment
- Mana Wahine Ki Wahine Toa, women's group
- Ha Tane – men's group
- Listening Ear – need to talk? Mon-Fri 9am-4pm no appointments necessary, cuppa and a listening ear available

Waitata Sessions 12:30pm every Wednesday, in our hall, come along for a sing along.

Community Connections 10:30am-12pm every Friday in our hall. Hot soup and cuppa available. The purpose of these sessions is for the community to get together and partake in different activities together, getting to know one another, sharing talents/hobbies/passions creating connections in the community, building friendships. The session topics are driven by interests of participants.

Coming up:

Friday 27th October – Basic Phone Photography
Friday 3rd November – How to Workshop, Basic Sewing Repairs & Car Maintenance
Friday 10th November – 3 Steps 4 Life with St Johns

Follow us on social media –Facebook and Instagram for updates on what's happening here during the week.

www.bbtrust.co.nz

WANTED

OLD HAY FOR GARDEN MULCH, any quantity small or large. Phone 022 025 0090,

OLD NEWSPAPER Copies of the Bream Bay News, Advocate, Herald, Leader, Weekend Lifestyler, or Mangawhai Focus for recycling as erosion control. Waipu Lions fundraiser. Phone Dave Bell 09 432 0861.

VEHICLES WANTED. Top cash paid For any VANS, UTES, TRUCKS, 4X4, Dead or Alive, damaged, de-registered Mechanical problem, no WOF we buy it. Call 0800 333 398

SITUATIONS VACANT

BREAM BAY NEWS DELIVERY PERSON NEEDED

Twice monthly for the Ruakākā Village area.

Earn money while you exercise.

Phone or text Marilyn 027432 0070.

or email:breambaynews@xtra.co.nz

FOR HIRE

SHIPPING CONTAINERS

20ft Shipping Containers, hire offsite \$180 per month + GST + Del, minimum 3 months,
Ph 0212722739 / 021432701

Marsden Yacht & Boat Club

Clubhouse For Hire

Available to Community Groups for regular hire, weekdays and evenings

Fees only \$30.00 for half day sessions

Also suitable for Corporate Hire, Conferences, etc.T's and C's apply

Good facilities.

Enquiries to K. Walker, Ph. 4327422

LIBRARY HOURS

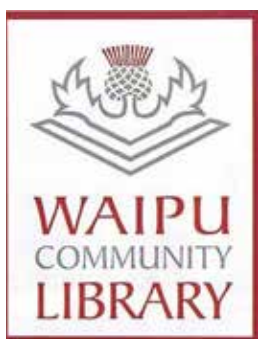

Monday, Wednesday,
Thursday, Friday &
Saturday 10am - 1pm.
Tuesday 10am - 4pm.
Phone 432 0375



RUAKAKA COMMUNITY LIBRARY
Takutai Place, Ruakaka
432 8406
Mon - Fri 9:30am-3:30pm
Sat 9am-1pm

JP Service available
Saturdays 10am - 11am.

MARKETS



Handmade & Homegrown
ARTS | CRAFTS | FOOD

Sunday 10 December
9:00am - 1:00pm
Waipu Coronation Hall

Claire | 021 272 2294

Kate | 021 064 5698

www.waipumarket.co.nz

PUBLIC NOTICES



Bream Bay Medical Centre Ltd.
Ruakākā Town Centre, Ruakākā

Monday - Friday: 8.45 am - 5pm
Saturdays: 9am - 12pm

Marsden Cove Medical Centre
1A Ngawaka Lane, One Tree Point

Monday - Friday: 8.45am - 5pm

Please advise at time of booking
if you require an extended consultation

Ph: 432 8060

New patients welcome

Marsden Bay Garden Club



Monthly Meetings held
3rd Thursday of the
month.

ALL WELCOME

1:00 pm – Ruakākā Hall
– Sandford Rd

Contact – Secretary –
0210515581

**LOCAL PEOPLE
READ THE BREAM
BAY NEWS
IT IS AN
EFFECTIVE PLACE
TO ADVERTISE**

BREAM BAY 60's UP

WHERE: Ruakaka Recreation Centre
9 Takutai Place

WHEN: the 4th Friday of the month
At 10:00am for games, indoor bowls etc.
Speaker or Entertainer at 1:30 pm

Monthly bus trips.

New Members Welcome

EMAIL – breambay60sup@gmail.com

Or phone Secretary 021 491 887



Justices of the Peace

Ruakākā

Paea Paki 09 432 8262/021 149 1625
Darrell Trigg 09 432 7256/021 332 901
Ken Orr 09 432 8215
Wayne Buckland 022 644 5376.

One Tree Point

Jules Flight 0274 777 210
Sir John Goulter 021 612 442
MM Jolley 027 415 9486
Ian Bogue 0274 300 418
Grant Brown 027 248 7126

Waipu

Trevor Vaile 021335 075
Doug Scott 027 229 9752
Ken Couper 027 292 0524
Angela Stolwerk 021 823 966
Chris Martin 027 367 2947

Make contact with a Justice of the Peace
(on any day) and make an appointment to have
your documents completed.

A service desk also operates 10am to 11am on
Saturdays in the Ruakaka Library.



JULIE BROWN

would like to thank everyone who made
her 100th birthday so special.
Thank you to those who popped in to wish
her Happy Birthday on November 4 and
to those who phoned, sent cards or made
special visits to see her in Ranburn.

BREAM BAY SUNDAY CHURCH SERVICES

Presbyterian Camellia Ave, Ruakaka:
8.45am. The Centre, Waipu: 10.15am.
Prayer Service: 7pm

Encounter 223 Marsden Pt. Rd,
Ruakaka, 10am.

Anglican - All services at ST PAUL's
Church, 25 Karawai St, Ruakaka 9.30am
until further notice.

Catholic Holy Family Church,
Ruakaka, 10.30am. Mass or Liturgy of
the Word

Lifepoint. 300 OTP Rd, 10.30am.

NORTHPINE COMMUNITY LIAISON COMMITTEE

This committee meets periodically to review the
environmental performance of the Northpine tim-
ber manufacturing plant in Waipu, in consultation
with representatives of the local councils. Any
Waipu resident with concerns about the environ-
mental effects of the Northpine plant should notify
the Northpine office (432 1155). Concerns will be
recorded, considered and subsequently reviewed
by the liaison committee. The Independent chair-
person of the liaison committee is Steve Goldthor-
pe 0274 849 764.

THE NEXT PUBLICATION DATE

of the Bream Bay News will be Thursday 21 December
The deadline for all copy is 4pm on
Wednesday 13 December

Harcourts Waipu

Vacant and Price Reduced! WAI2555
\$915,000

- 612m2 site – fully fenced, private backyard
- 4 bedrooms, modern – master with ensuite
- Open plan kitchen, dining and living area
- Separate lounge with heat pump which flows out to a patio and flat lawn
- Backyard - secure place for the kids to play
- Internally accessed double garage
- Flat stroll to Waipu village

Lyndie Mullins 021 101 6389

Walk to School, Park and Village WAI2562
\$725,000

- 3-bedroom, 1-bathroom solid, brick home
- 556m2 section – flat and established
- Situated minutes from Waipu Primary School
- 5-minute walk to the local shops
- Separate bath and open wet room shower
- Lounge and dining area flows out to patio
- Off Street parking for family and friends
- Double garage provides ample storage

Judy Guy 027 221 5623

Where Size and Location Count WAI2593
AUCTION (unless sold prior)

- Well-presented, 2-storey, 4-bedrm home
- 3 bedrooms and open plan living upstairs
- Huge space downstairs for the teenagers
- Private backyard, flat 814m2 section
- Covered patio with a hot-tub
- Easy stroll to Waipu Village
- Selling "as is" – unconsented work

Open Homes - Sat / Sun 1.00 – 1.45pm
Auction Onsite - 6 Ferry Road, Waipu
Wednesday 17th January 2024 at 6pm
Christine Tierney 027 488 1883

Harcourts Waipu | 7 The Centre, Waipu | 09 432 4000

Waipu Real Estate Ltd Licensed Agent REAA 2008

Christmas is a time for family, giving, and celebrating.

For those looking to buy or sell real estate, it's a great time of year to do so!

I specialize in helping families find or sell their home in Bream Bay, I know it well **I've lived here for 40 years.**

I understand the unique needs of each family, and work hard to make sure you get the home of your dreams.

Learn about our complimentary marketing package and **FREE professional photography offer.**

With the lowest fees in the bay **you will save thousands.**

Tina Subritzky ★★★★★

📞 021 059 7285 ✉️ tina.s@arizto.co.nz

ARIZTO Licensed Salesperson (REAA 2008)

BBR

BREAM BAY REALTY

BREAM BAY REALTY LIMITED (LICENSED: REAA 2008)

Shop 11 | Town Centre | Ruakaka 0116 | NZ
PH: 09 433-0300 | bbrealty.co.nz
info@bbrealty.co.nz

Proud sponsors

NEW LISTING

CAMP OR RELOCATE ON THE RIDGE

Tucked away off the road is this new section, close to Ruakaka Town Centre and a short drive to the beach. Sections with no covenants are very rare, get in now!! 515m2 (480m2 nett). **NEW TITLE—170B Marsden Point Road. Price \$449,000 | [#4168](http://bbrealty.co.nz)**

FIONA SOUTHERN MNZM
Mob: 021 317 775

COASTAL CONVENIENCE

This much-loved home has a thoughtful layout with easy flow, large windows and doors allowing light to filter into every room. Open plan living, dual ranchsliders opening out to patio & archgola. Three large bedrooms, two bathrooms. Fully fenced section and gated on two sides. **Price \$850,000 | [#4167](http://bbrealty.co.nz)**

JANINE GOLDSMITH AREINZ
Mob: 021 432 793

OPEN HOME—SUNDAY 12.00—12.45pm
371 One Tree Point Road, One Tree Point

NEW LISTING

VIEWS OF MT MANAIA & WHANGAREI HEADS

Located in a quiet street amongst quality new built homes this 631 sq mtr level section is an ideal building site for your new home. Title is issued. A short walk to the beach from here, or a short drive to the Marina to launch the boat, a great lifestyle opportunity awaits. **Price \$339,000 | [#4170](http://bbrealty.co.nz)**

JOANNE DEWSON AREINZ
Mob: 021 780 622

CENTRAL 10 ACRE BLOCK

A rare find in a sought-after location. Sandy, black peat soil and currently maintained by way of maize planting and stock grazing, this land is a flat rectangular shape. Wide road frontage and exposure on One Tree Point Road lends itself to lifestyle possibilities. **[#4163](http://bbrealty.co.nz)**

Price Now \$699,000 + GST (if any)
FRANCIE STOKES
Mob: 022 656 0165

• **Obligation Free Appraisals**

• **Very Competitive Fees**

• **Substantial Marketing Packages Available**

As the longest established Real Estate Company in the Bream Bay our strategy has been consistent.

Satisfied clients and customers, repeat business, working relationships that turn into friendships.

We work as a Team to generate an outcome that is the right fit for you.

OUR DOOR IS ALWAYS OPEN

10% Discount for SuperGold Card Holders